

# lucky shamrock

Lapel Pin / Pencil Topper



Materials needed: (to make one shamrock)

3



20 mm Heart Beads  
1182-096 (Grasshopper)

1



12" Chenille Stem  
(Green)

Tools needed



wire  
Cutters



round-nose  
pliers



long-nose  
pliers

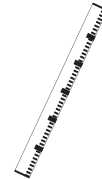

ruler

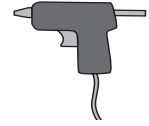

glue gun

1

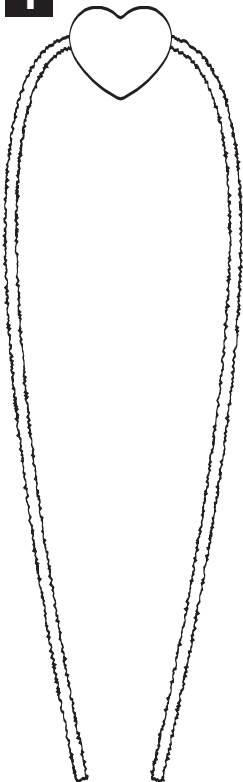

2

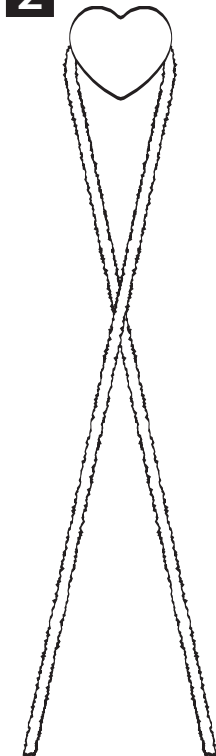

3

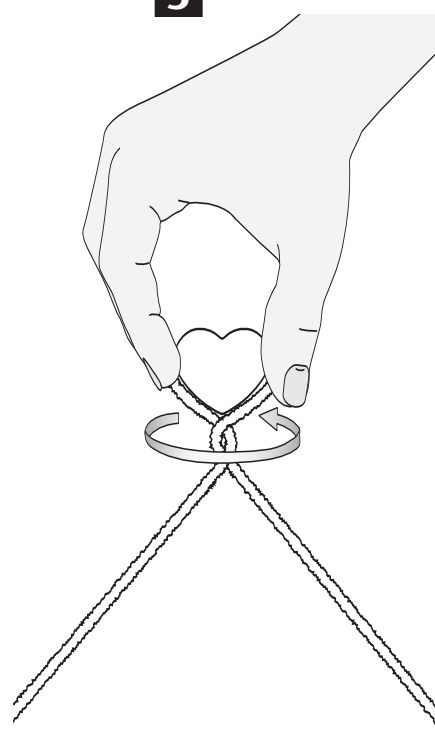

4

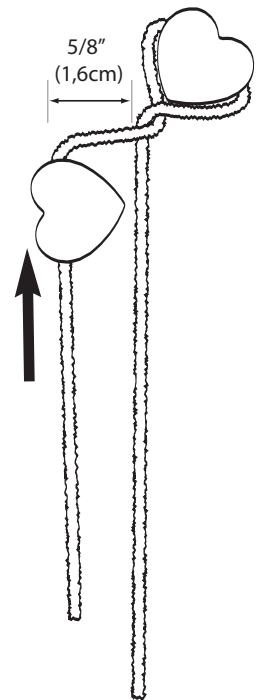

© 2008 Greene Plastics Corporation

**THE BEADERY**<sup>®</sup>  
CRAFT PRODUCTS

Project Sheet #0802

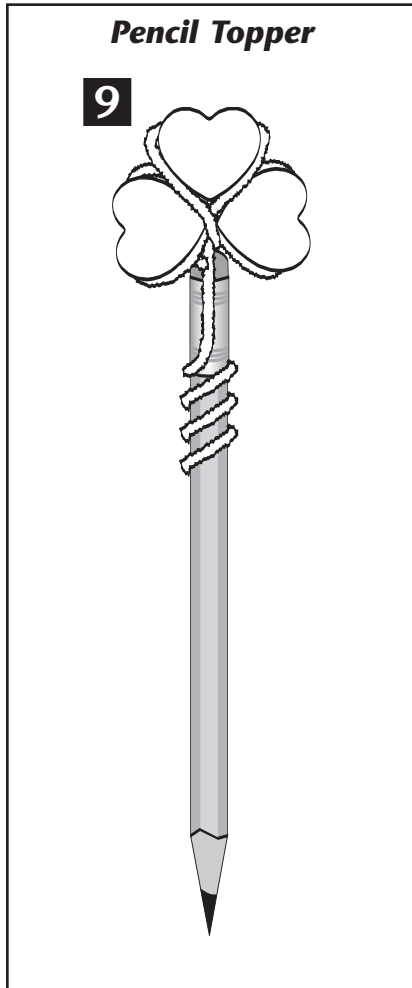
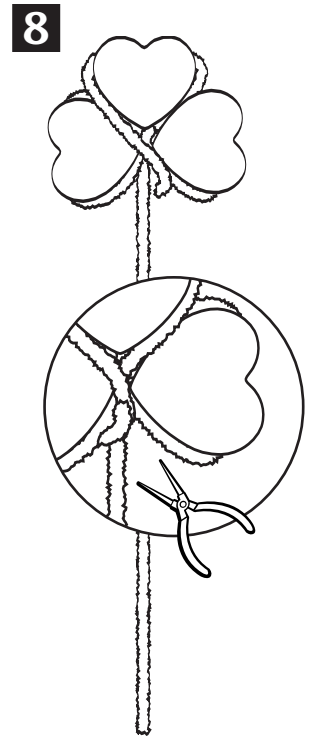
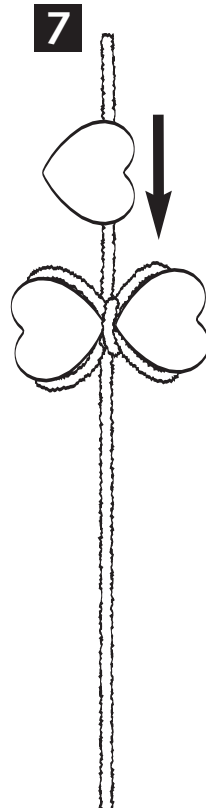
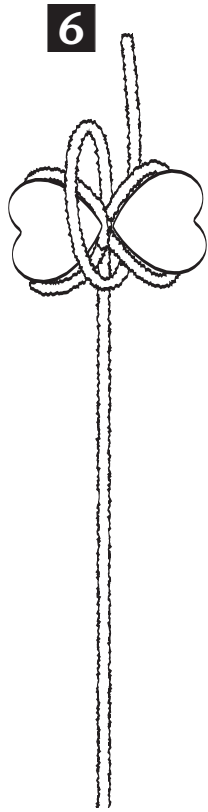
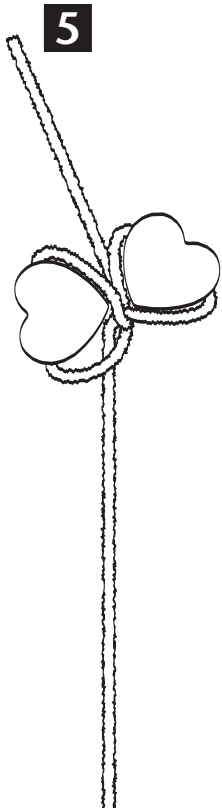

**or**

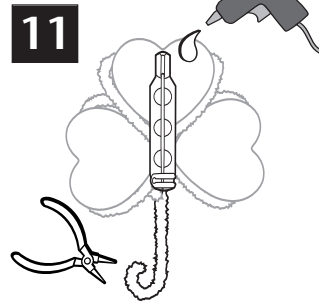
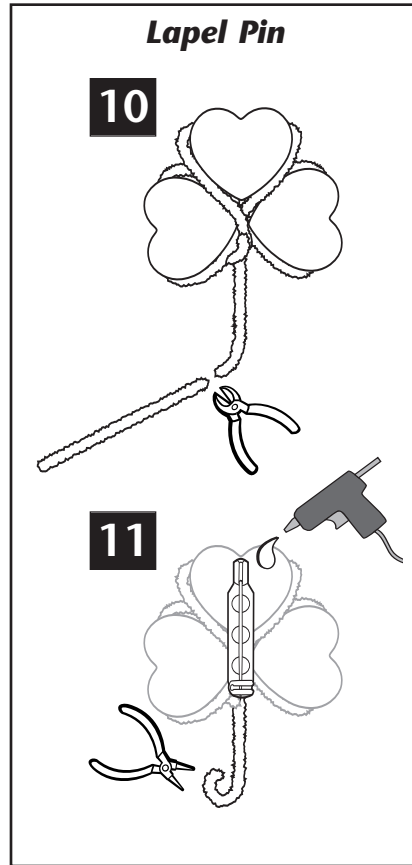

© 2008 Greene Plastics Corporation

**THE BEADERY®**  
CRAFT PRODUCTS

Project Sheet #0802