

# Single



## Band Placement

Place the loom on the table with arrow pointing away from you. This bracelet only uses 2 rows of pins.

**Step 1:** Use your fingers to place a red band on the loom. Push it down on the pins.

**Step 2:** Add a white band and push it down on the pins.

**Step 3:** Continue to place red and white bands on the loom pins until you reach the top (see diagram).

### Step 1

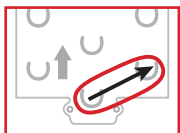

Place the first red band

### Step 2

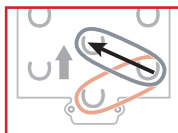

Place the first white band

## Diagram

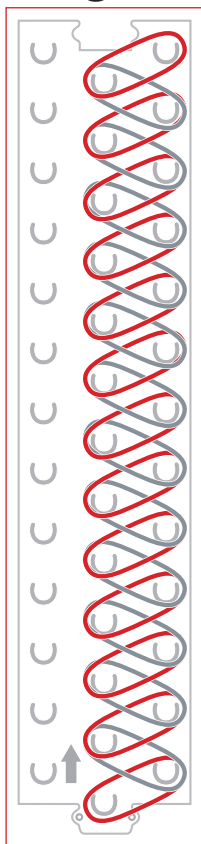

## Looping

Turn the loom around so the arrow points toward you. Always use the pick tool to pick up and loop the bands.

**Step 1:** Use the pick tool to go down into the center pin hole.

**Step 2:** Keeping the band on the hook, loop the white band over the pin to the left.

**Step 3:** Go down into the next pin hole on the left and pick up the red band. Pull it up and off the pin.

**Step 4:** Loop the red band over to the center pin.

### Step 1



Grab the white band on the center pin

### Step 2

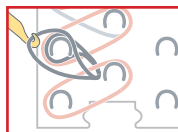

Loop the white band to the left pin

### Step 3

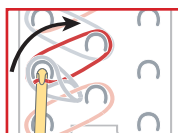

Grab the red band on the left pin

### Step 4

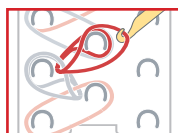

Loop the red band to the center pin

**Step 5:** Continue picking up and looping the red and white bands until you've looped the last red band.

**Step 6:** Slide a C-clip over the red band loops.

### Step 6



Slide a C-clip on the red band loops

**Step 7:** Carefully pull all the bands from the pins.

**Step 8:** Join the bracelet by slipping the C-clip through the loop at the beginning of the bracelet.

# Triple Single



## Band Placement

Place the loom on the table with arrow pointing away from you. Use your fingers to place the bands on the loom. Follow the steps when placing bands. Push each band down after you place it on the pins.

**Steps 1-3:** Place bands on each pin row, starting with yellow and referring to diagram for color sequence.

### Step 1

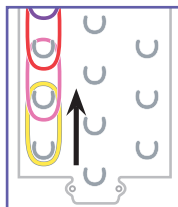

Place bands on the left row of pins

### Step 2

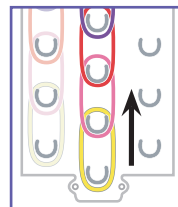

Place bands on the middle row of pins

### Step 3

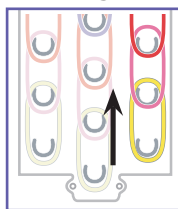

Place bands on the right row of pins

## Diagram

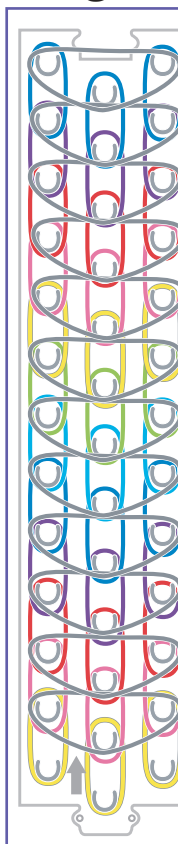

**Step 4:** Place white bands in triangles as shown on the diagram.

## Looping

Turn the loom around so the arrow points toward you. Always use the pick tool to pick up and loop the bands.

### Step 1

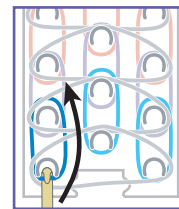

Grab the blue band on the left pin

### Step 2

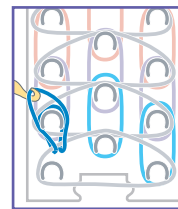

Loop the blue band straight up to the next pin

### Step 3

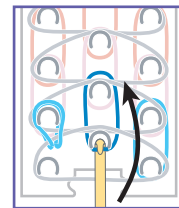

Grab the blue band on the center pin

### Step 4

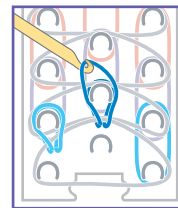

Loop the blue band straight up to the next pin

### Step 5

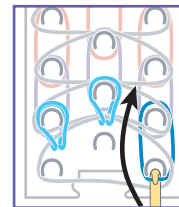

Grab the blue band on the right pin

### Step 6

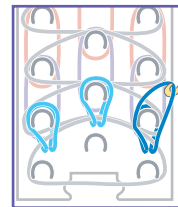

Loop the blue band straight up to the next pin

**Step 7:** Continue picking up and looping the bands until you reach the top of the loom. Finish the bracelet with a white extension and C-clip. (see reverse)



# Making a Bracelet Extension

Many Bracelets need an extension to be long enough to wear. The extension is also made on the loom pins.

## Removing Bracelet from the loom

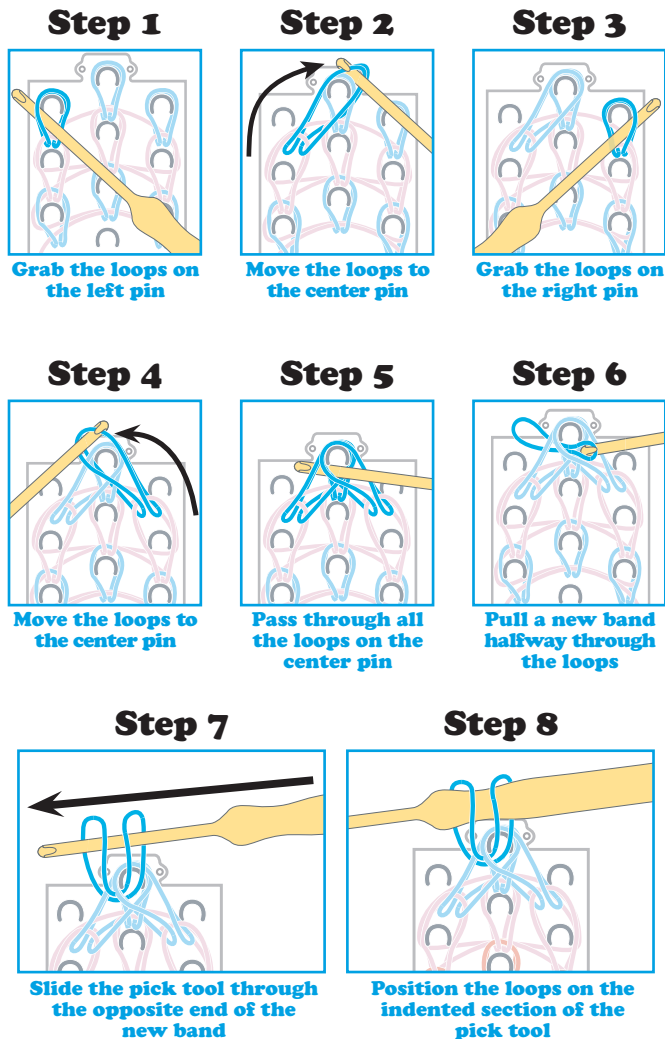

**Step 9:** Carefully remove the bracelet from the pins and set aside.



©2013 The Beadery® Craft Products  
P.O. Box 178 Hope Valley, R.I. 02832  
1-401-539-2432

www.thebeadery.com



Scan for project ideas and instructions.

## Band Placement

Place the loom on the table with arrow pointing away from you. Starting at the loom bottom, use your fingers to place the bands on the loom (refer to your project instructions for band color and follow diagram below).

Push each band down after you place it on the pins.

## Diagram

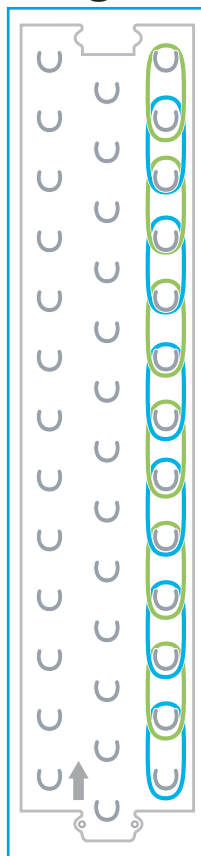

## Looping

Turn the loom around so the arrow points toward you. Always use the pick tool to pick up and loop the bands.

